

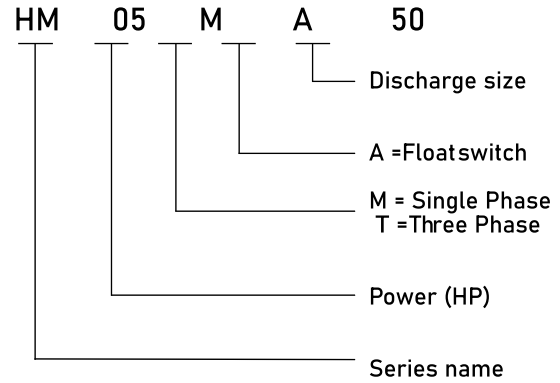

**Submersible Drainage &
Sewage Pumps**

50 Hz



Applications

- Basement water removal
- Waste water drainage
- Water transfer
- Sump / effluent handling
- Dewatering
- Fish pond & fountain circulation
- Sewage handling
- Factory waste water handling

Motor Data

- Motor Type : 2POLE , dry type
- Frequency : 50Hz
- Nominal Speed : 2850 rpm
- Insulation Class : F class (155°C)
- Enclosure Protection Class : IP 68
- Protection Device :
Thermal Protector (Single phase)
Overload Protector (Three phase)

Pump Data

- Impeller : Vortex Impeller
- Shaft Seal / Mechanical :
Double Mechanical Seal
- Bearing :
Double-shielded Ball Bearing

Operation Conditions

- Fluid Temperature: 0 to 40°C

No.	Component	Material
1	Cable	H07RN-F or VCT
2	Handle	Nylon6+30GF
3	Motor cover	ADC-12
4	Bearing cap	SECC
5	Motor frame	ADC-12
6	M.Seal bracket	FC200
7	Cable base	Nylon6+30GF
8	Motor shaft	AISI410
9	Mechanical seal	CA / CE, SIC/SIC
10	Oil seal	NBR70
11	Impeller	FC25
12	Pump casing	FC200
13	Flange	FC200
14	Strainer	PVC

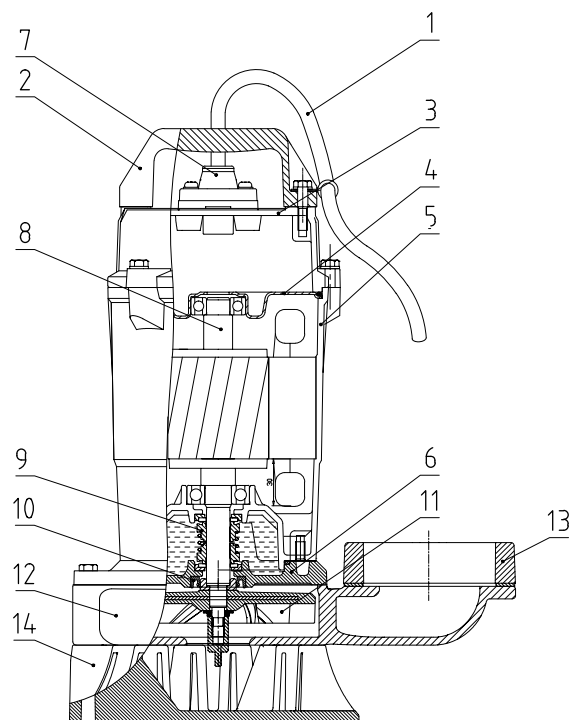

Performance Curve

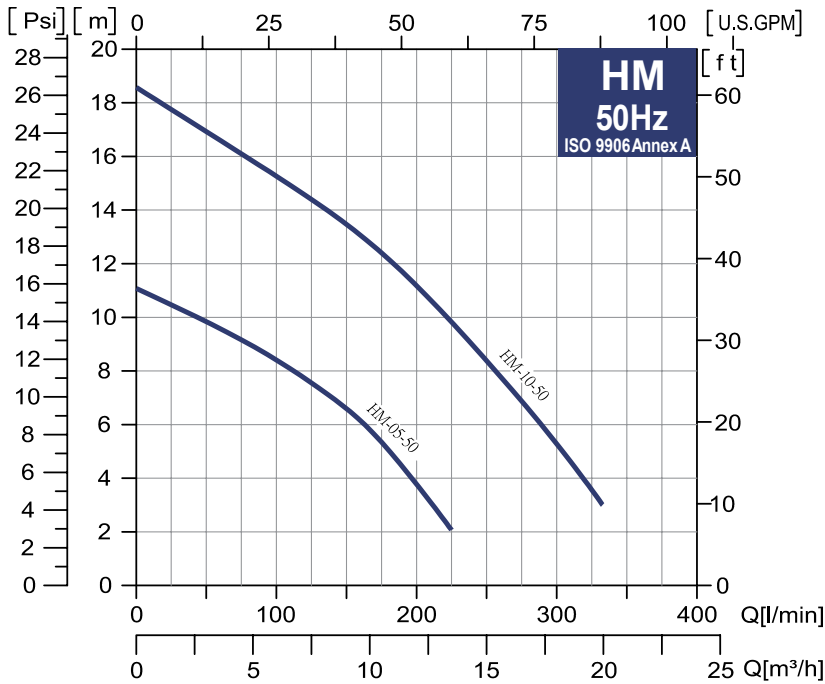

Q=Capacity				
l/min	0	100	200	300
m³/h	0	6	12	18
H=Total manometric head				
HM 05M50	11.0	8.6	3.6	
HM 10M50	18.6	15.3	11.6	5.7

Technical data

Single phase

Model	Power		Nominal Current (A)		Capacitor	Connection	Discharge (inch)	Head		Flow		Solid Passage (mm)	Cable (m)	N.W. (kg)	
	HP	kW	220-240V					220-240V [UF]	[V]	Rated (m)	Max. (m)				Rated (l/min)
HM-05M50 HM-05MA50	0.5	0.37	2.7 - 2.5		12	450	flange	2"	7	11.0	140	225	10	10	12.9
HM-10M50 HM-10MA50	1.0	0.75	5.8 - 5.4		20	450	flange	2"	10	18.6	230	335	10	10	15.1
HM-10M80 HM-10MA80	1.0	0.75	5.8 - 5.4		20	450	flange	3"	10	18.6	230	335	10	10	15.1

Three phase

Model	Power		Nominal Current (A)		Connection	Discharge (inch)	Head		Flow		Solid Passage (mm)	Cable (m)	N.W. (kg)		
	HP	kW	220-240V				380-415V	Rated (m)	Max. (m)	Rated (l/min)				Max. (l/min)	
HM-05T50	0.5	0.37	2.2 - 2.0		1.3	1.2	flange	2"	7	11.0	140	225	35	10	11.9
HM-10T50	1.0	0.75	3.6 - 3.4		2.1	1.9	flange	2"	10	18.6	230	335	35	10	14.1
HM-10T80	1.0	0.75	3.6 - 3.4		2.1	1.9	flange	3"	10	18.6	230	335	35	10	14.1

Dimensions and weights

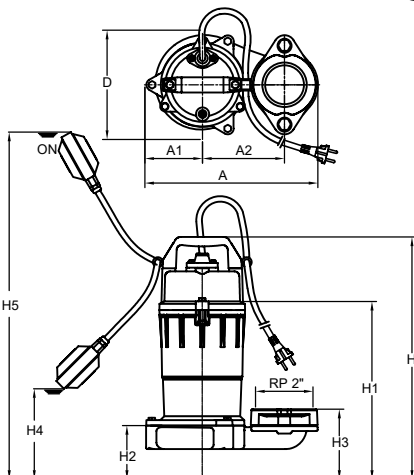

Model	Phase	Dimensions (mm)									
		A	A1	A2	D	H	H1	H2	H3	H4	H5
HM-05-50	1-3	254	95	120	180	365	264	90	110	115	535
HM-10-50(80)	1-3	285	95	135	180	380	279	90	116	130	550



Operating Condition	Applications	Waste water and Sewage for domestic purposes
	Fluid Temperature	0 to 40°C
Motor	Type	Dry Type
	Pole	2-pole
	Insulation	Class F
	Protection	IP68
	Protection Device	Thermal Protector (single phase) Overload Protector (three phase)
Pump	Impeller	Vortex Impeller
	Shaft Seal/Material	Double Mechanical Seal and one Oil Seal
	Bearing	Double-Shielded Ball Bearing

Component	Material
Cable	H07RN-F
Handle	Nylon SS 41
Motor cover	Cast Iron GJL 200
Seal housing	Cast Iron GJL 200
Bracket	Cast Iron GJL 200
Oil chamber	Cast Iron GJL 200
Pump casing	Cast Iron GJL 200
Impeller	Cast Iron GJL 200
Mechanical seal: Upper	CA/CE
Lower	Sic/Sic
Oil seal	NBR
Shaft	AISI 410
Motor housing	AISI 304

● Performance Curve

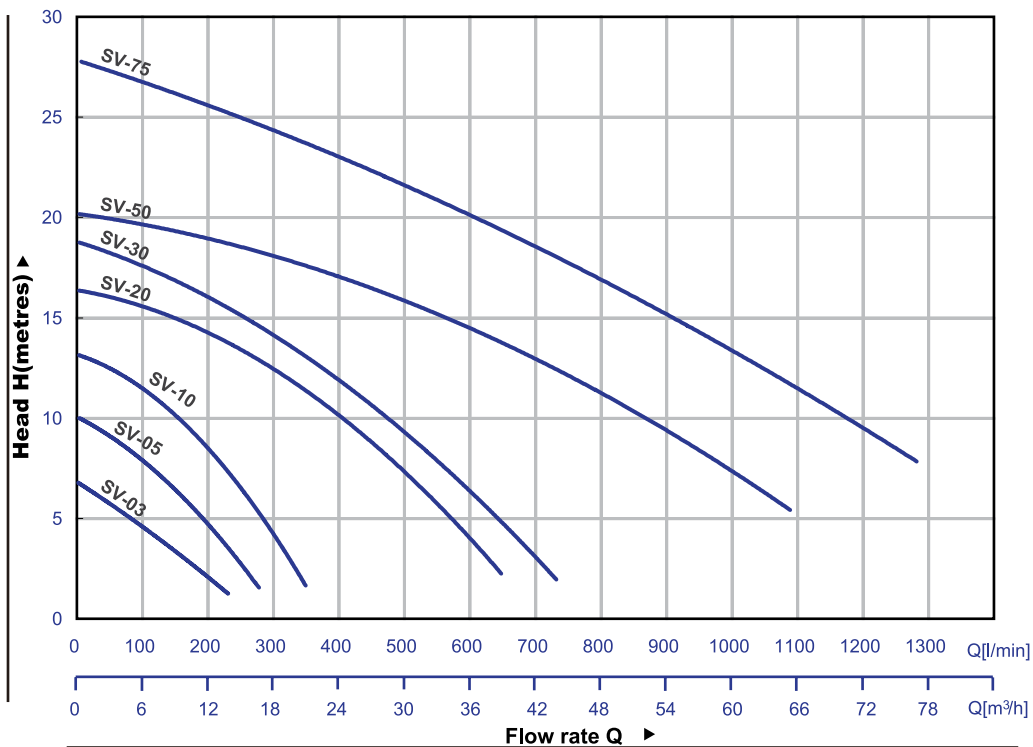

● **Technical data**

Model	Power		Phase	Discharge (inch)	Head		Flow		Solid Passage (mm)	Cable (m)	N.W. (kg)
	HP	kW			Rated (m)	Max. (m)	Rated (l/min)	Max. (l/min)			
SV-03-50	0.3	0.25	1PH / 3 PH	2"	4	7	120	220	35	10	12.5
SV-05-50	0.5	0.37	1PH / 3 PH	2"	6	10	150	280	35	10	13.5
SV-10-50	1.0	0.75	1PH / 3 PH	2"	8	13.5	200	350	35	10	18.5
SV-20-50(80)	2.0	1.50	1PH / 3 PH	2"/3"	10	17	400	650	35	10	34
SV-30-50(80)	3.0	2.20	3PH	2"/3"	11	19	450	750	35	10	35
SV-50-80(100)	5.0	3.70	3PH	3"/4"	15	20	550	1100	50	10	57
SV-75-80(100)	7.5	5.50	3PH	3"/4"	20	28	600	1200	50	10	63

SV-03-50 - SV-05-50: Threaded Flange Type
 SV-10-50: Threaded Flange Type or Elbow Type (2")

SV-20-50(80) - SV-30-50(80): Elbow Type (2" or 3")
 SV-50-80(100) - SV-75-80(100): Elbow Type (3" or 4")
 Auto Float Switches are available in Single Phase

● **Dimensions and weights**

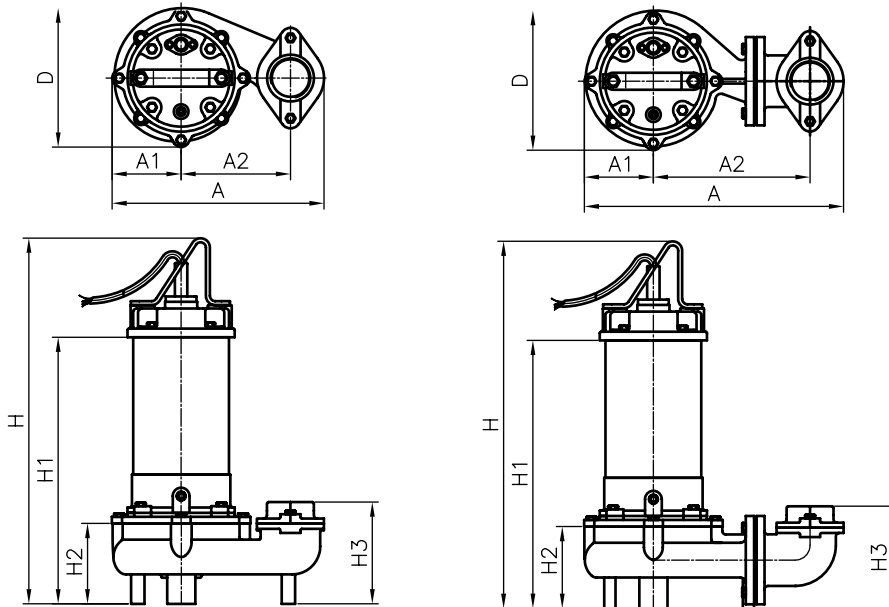

Model	Dimensions (mm)							
	A	A1	A2	D	H	H1	H2	H3
SV-03-50	222	73	115	145	385	272	113	133
SV-05-50	222	73	115	145	410	297	113	133
SV-10-50	222	73	115	149	464	340	113	133
SV-20-50(80)	387	103	234	208	548	400	122	153
SV-30-50(80)	387	103	234	208	568	420	122	153
SV-50-80(100)	459	110	256	227	638	471	160	220
SV-75-80(100)	459	110	256	227	678	511	160	220



Operating Condition	Applications	Waste water and Sewage for domestic and industrial purposes
	Fluid Temperature	0 to 40°C
Motor	Type	Dry Type
	Pole	2-pole
	Insulation	Class F
	Protection	IP68
	Protection Device	Thermal Protector (single phase) Overload Protector (three phase)
Pump	Impeller	Vortex Impeller
	Shaft Seal/Material	Double Mechanical Seal and one Oil Seal
	Bearing	Double-Shielded Ball Bearing

Component	Material
Cable	H07RN-F
Handle	AISI 304
Motor cover	AISI 316
Seal housing	AISI 316
Bracket	Cast Iron GJL 200
Oil chamber	AISI 316
Pump casing	AISI 316
Impeller	AISI 316
Mechanical seal: Upper	CA/CE
Lower	Sic/Sic
Oil seal	VITON
Shaft	AISI 316
Motor housing	AISI 316

● Performance Curve

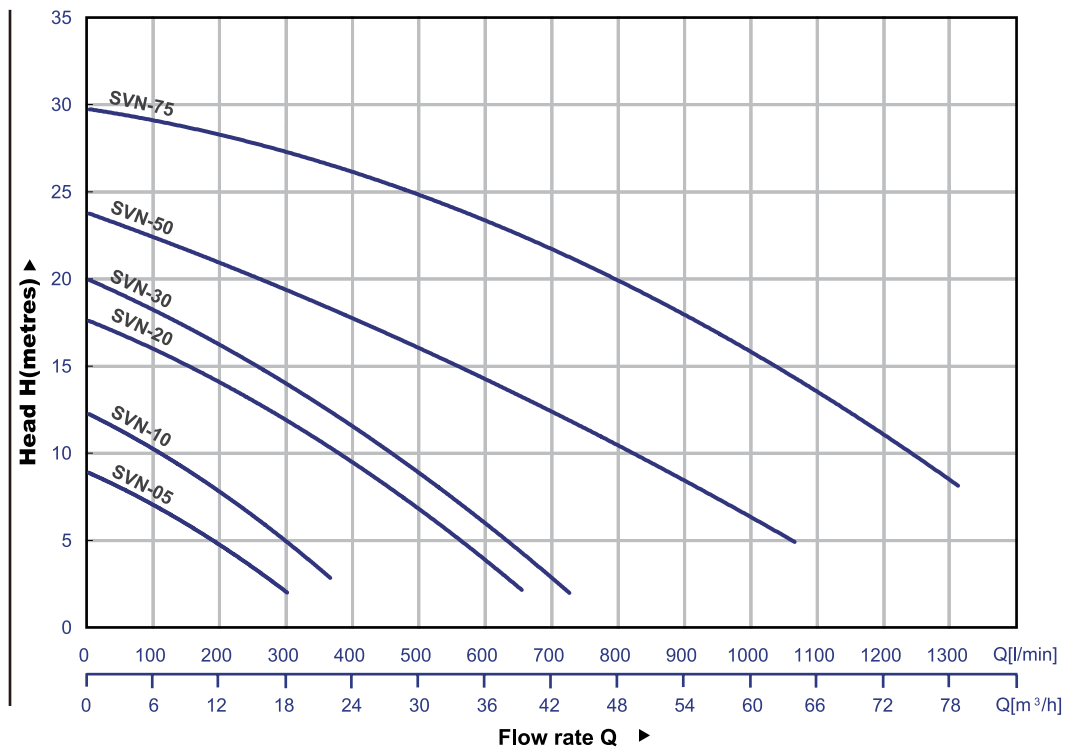

• Technical data

Model	Power		Phase	Discharge (inch)	Head		Flow		Solid Passage (mm)	Cable (m)	N.W. (kg)
	HP	kW			Rated (m)	Max. (m)	Rated (l/min)	Max. (l/min)			
SVN-05-50	0.5	0.37	1PH / 3 PH	2"	6	9	150	300	35	10	13.5
SVN-10-50	1.0	0.75	1PH / 3 PH	2"	8	13	200	400	35	10	18.5
SVN-20-50(80)	2.0	1.50	1PH / 3 PH	2"/3"	12	18	300	700	35	10	34
SVN-30-50(80)	3.0	2.20	3PH	2"/3"	13	20	350	750	35	10	35
SVN-50-80(100)	5.0	3.70	3PH	3"/4"	15	24	550	1100	50	10	57
SVN-75-80(100)	7.5	5.50	3PH	3"/4"	20	30	700	1300	50	10	63

SVN-05-50: Thread Type

SVN-10-50: Thread Type or Elbow Type (2")

SVN-20-50(80) - SVN-30-50(80): Elbow Type (2" or 3")

SVN-50-80(100) - SVN-75-80(100): Elbow Type (3" or 4")

Auto Float Switches are available in Single Phase

• Dimensions and weights

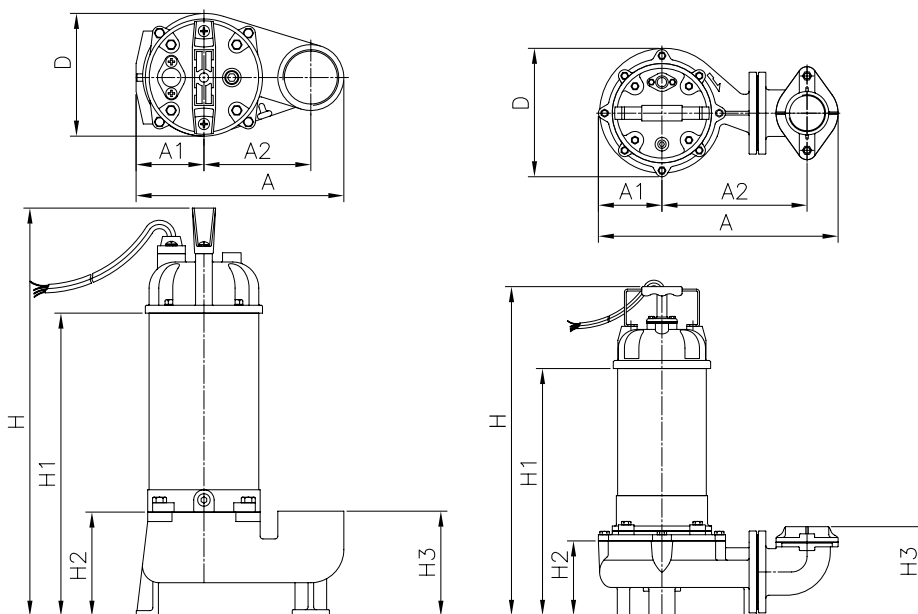

Model	Dimensions (mm)							
	A	A1	A2	D	H	H1	H2	H3
SVN-05-50	224	73	115	132	409	296	112	113
SVN-10-50	224	73	115	132	439	326	112	113
SVN-20-50(80)	387	103	234	205	530	398	120	143
SVN-30-50(80)	387	103	234	205	550	418	120	143
SVN-50-80(100)	459	110	256	230	641	471	160	220
SVN-75-80(100)	459	110	256	230	681	551	160	220

ABC PUMPS BRANCHES:

EASTERN CAPE, PORT ELIZABETH (HEAD OFFICE)

134 Montmedy rd, Theescombe,
Tel: 041 379 2912, Fax: 041 379 2432
admin@abcpumps.co.za

FREESTATE ,BLOEMFONTEIN

Unit 2, DIY Square, 2-5 Hornby St. Oranjesig
Tel: 051 430 0771, Fax: 051 430 0773
adminbfm@abcpumps.co.za

NORTHAN CAPE, KIMBERLEY

9 Carlstein rd, Kimindustria
Tel: 053 841 0172
ft@abcpumps.co.za

WESTERN CAPE, CAPE TOWN

12 Traka Street, Stikland Industrial
Tel: 021 945 1530, Fax: 021 945 1523
adminwc@abcpumps.co.za

WESTERN CAPE, GEORGE

24B Wellington Street
Tel: 082 451 4745, Fax: 041 379 2432
polla@extremesales.co.za

GAUTENG, JOHANNESBURG

A6, Ficestar Junction cnr of Beyers Naude & Juice Street Honeydew
Tel: 011 794 2846, Fax: 011 794 2495
adminjhb@abcpumps.co.za

